

MIXER AIRTECH TOP powder conveying group - Type 100 RIETSCHLE - Electric panel

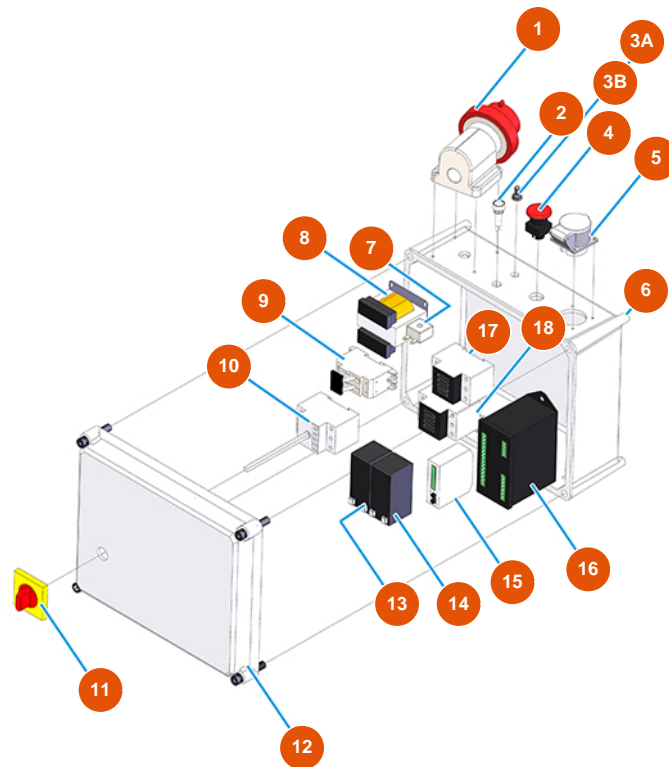

Détails des pièces

Pos.	Référence	Désignation
1	3C03000305	3-pin + neutral + ground 32A surface-mount male plug
2	8055000100	Led / led hose D.10 MM
3A	3C02100100	Rubber protection for switch
3B	3C01800200	Commutator switch (1)-0-(1) FASTON T115 G-A
4	3C04000510	Red emergency button
5	3C02600100	2-pin + ground 16A / 42V female inclined plug
6	3C00110457	6
7	3C00500503	Transformer AMPEROM.25A R=1:400
8	3C00500402	Transformer 70/80VA 400/42/24/15
9	3C05050501	Fuse holder bipolar 10,3X38
10	3C01030108	ABB-MS325 20A magnetic
11	3C01300207	Maneuver x ABB red/yellow IP64 MS1



Pos.	Référence	Désignation
12	3C00110158	12
13	3C00120100	Lead battery 12V 1,2AH
14	3C00120100	Lead battery 12V 1,2AH
15	3C00120200	Battery charger module AIRTECH 24VCC
16	3C03201650	Black box programmer for AIRTECH
17	3C00700121	Tripolar contactor 11KW 24AC 1NO 1NC
18	3C00700121	Tripolar contactor 11KW 24AC 1NO 1NC