

Máquina de mezclado continuo MIXER PLUS CLASSIC - 60 Hz - Tablero electrónico

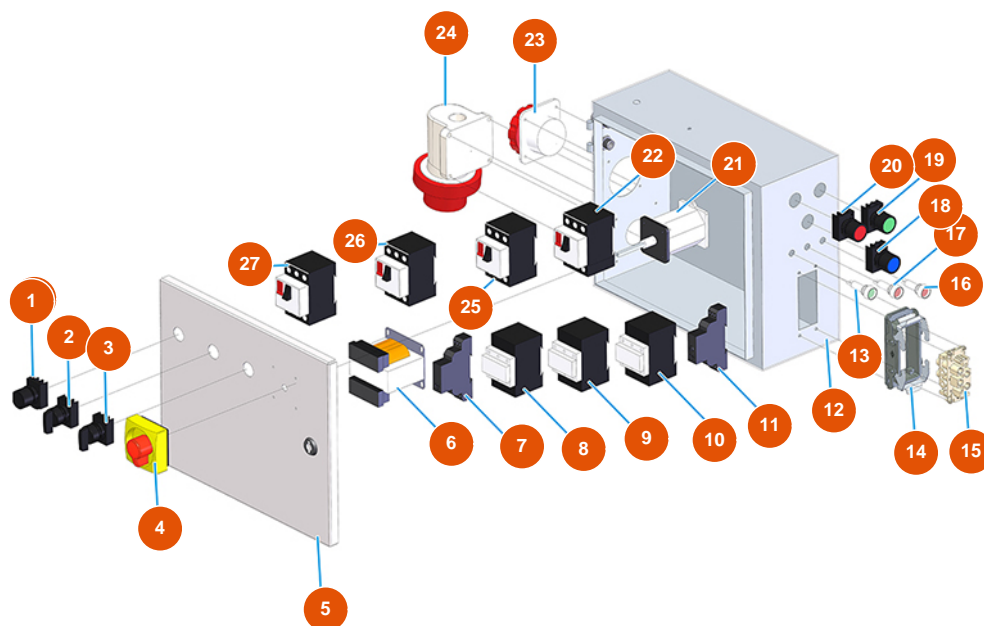

Détails des pièces

| Pos. | Référence | Désignation |
|------|------------|---|
| 1 | 3C04000101 | 1 |
| 2 | 3C04400800 | Interruptor de la bomba PLUS STANDARD |
| 3 | 3C04400700 | Interruptor rueda de celdas PLUS STANDARD |
| 4 | 3C04400207 | Inversor de fase completo PLUS STANDARD |
| 5 | 3C00102805 | 5 |
| 6 | 3C00500402 | Transformador 70/80VA 400/42/24/15 |
| 7 | 3C00601001 | Relé de fase de sentido del ciclo |
| 8 | 3C00700117 | Contactador 4 KW 24V AC SIEMENS |
| 9 | 3C00700117 | Contactador 4 KW 24V AC SIEMENS |
| 10 | 3C00700110 | 10 |
| 11 | 3C03750400 | Temporizador 2 hilos retrasados 24/230AC/DC |
| 12 | 3C00102805 | 12 |



| Pos. | Référence | Désignation |
|------|------------|---|
| 13 | 3C04000108 | 13 |
| 14 | 3C02800502 | Base empotrable 16 polos 2 niveles CHI 16 |
| 15 | 3C02700600 | Inserto hembra 4/2 polos 80A |
| 16 | 3C04000106 | Indicador luminoso naranja D.10 con cable de 24 V |
| 17 | 3C04000107 | 17 |
| 18 | 3C04000118 | Botón azul D.22 |
| 19 | 3C04000105 | Botón verde D.22 |
| 20 | 3C04000104 | Botón rojo D.22 |
| 21 | 3C04400207 | Inversor de fase completo PLUS STANDARD |
| 22 | 3C01040112 | 22 |
| 23 | 3C01040112 | 23 |
| 24 | 3C03000305 | Clavija saliente 3 polos + neutro + tierra 32A |
| 25 | 3C01040110 | 25 |
| 26 | 3C01040107 | 26 |
| 27 | 3C01040107 | 27 |