

## MIXER LIGHT plaster continuous mixing machine - 2,2 kW - Air group

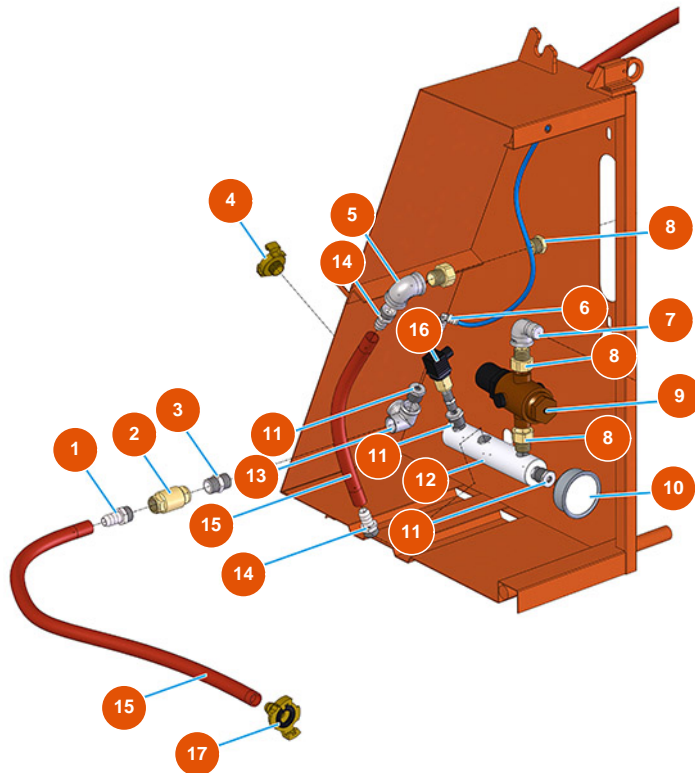

### Détails des pièces

Pos.	Référence	Désignation
1	3G50300202	Hose connector 3/8"X14
2	3G01300401	Valve RITEGNO EUROPA 3/8"
3	3G50300700	Steel reduced nipple 1/2X3/8
4	3A00100302	Male Geka coupling 1/2"
5	3G00509002	Elbow join galvanized 90° FF FIG.90 1/2
6	3G50200202	Legris coupling elbow joint 6X1/8
7	3G00509202	Elbow join galvanized 90° MF FIG.92 1/2
8	3G01700300	3 piece connector MF (I1)
9	3G00904100	Pressure reducer 1/2
10	3G00100141	Axial manometer 0-10 bar
11	3G50300100	Steel reduction 1/2X1/4
12	4044002500	12
13	3G00522102	Elbow outlet galvanized FIG.221 1/2

Pos.	Référence	Désignation
14	3G50300200	Hose connector 1/2"X14
15	3F00700201	PVC/rubber hose 13x19 (without Geka)
16	3G00403106	Pressure switch PT/5 0,6-2 BAR ITALT
17	3A00100102	PG15 Geka coupling 1/2"