

MIXER LIGHT plaster continuous mixing machine - 2,2 kW - Pump group

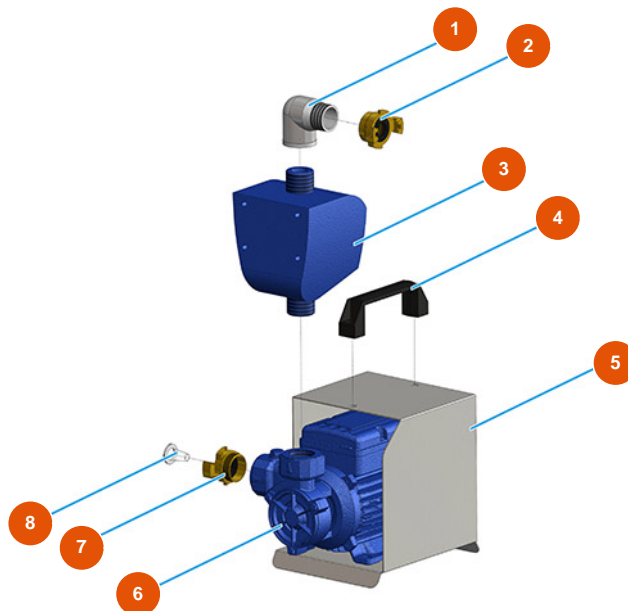

Détails des pièces

Pos.	Référence	Désignation
1	3G00509204	Elbow join galvanized 90° MF FIG.92 1"
2	3A00100204	Female Geka coupling 1"
3	3C06000100	3
4	3M00500114	Lifting handle
5	4044002900	5
6	3D00703001	Water pump for PLUS MONO and SPRINTER
7	3A00100303	Male Geka coupling 3/4"
8	3A00100600	Inox water filter