

MIXER PLUS TOP continuous mixing machine - Electrical box

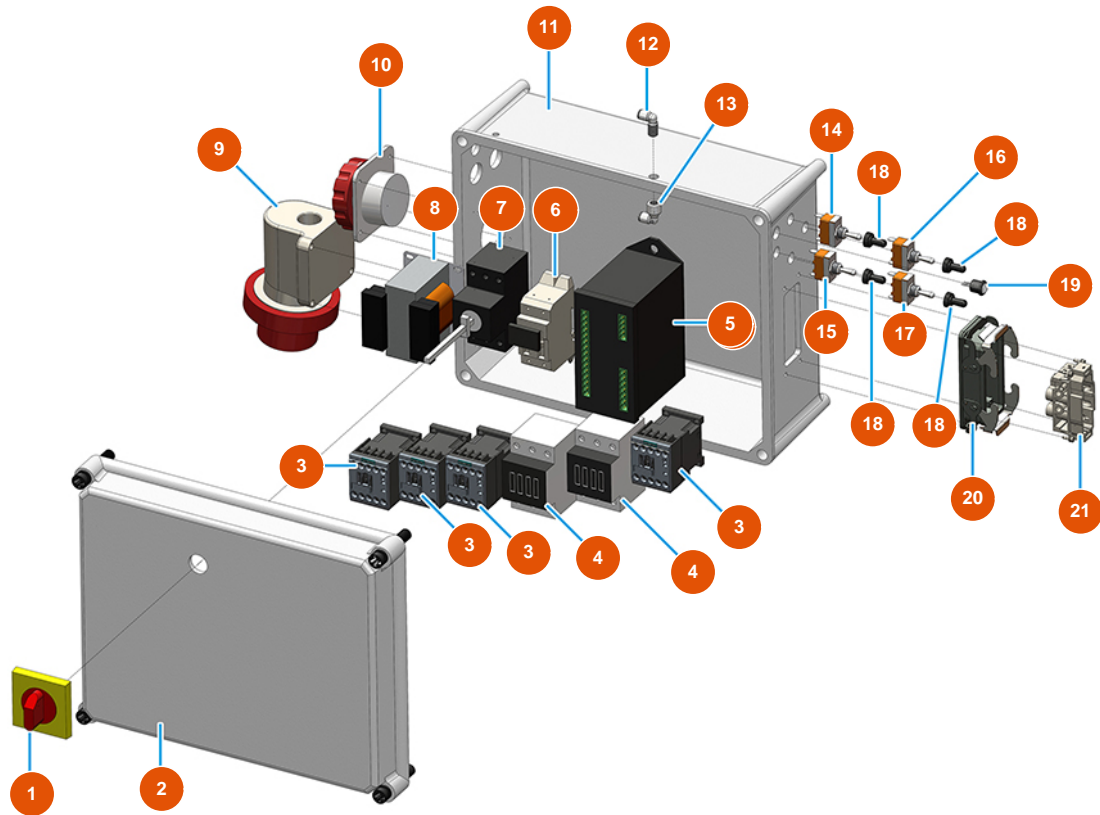

Détails des pièces

Pos.	Référence	Désignation
1	3C01300207	Maneuver x ABB red/yellow IP64 MS1
2	3C00110154	2
3	3C00700107	Contacteur ABB A8-30-01 4KW
4	3C00700307	Contacteur ABB A16-30-01 7,5KW
5	3C03201510	Black box programmer for PLUS TOP
6	3C05050500	Fuse holder unipolar 10,3X38
7	3C01030108	ABB-MS325 20A magnetic
8	3C00500402	Transformer 70/80VA 400/42/24/15
9	3C03000305	3-pin + neutral + ground 32A surface-mount male plug
10	3C02600203	3-pin+gr female inclined plug 16A GW 62231
11	3C00110454	11
12	3G50200201	Legris coupling elbow joint 6X1/8 M
13	3G50200103	Legris coupling 6X1/8 F 3114



Pos.	Référence	Désignation
14	3C01800500	Commutator switch 1-0 T115 A-A
15	3C01800800	Commutator switch 1-0-1 T215 T-A
16	3C01800100	Commutator switch 1-0-1 T115 E-A
17	3C01800200	Commutator switch (1)-0-(1) FASTON T115 G-A
18	3C02100100	Rubber protection for switch
19	8055000100	Led / led hose D.10 MM
20	3C02800502	16-pin socket base with 2 levers
21	3C02700700	10-pin female insert 16A 400V CNF 10